

ULTRA CATALOG

4–way

| | |
|-------------------------|----|
| 4–way feature end frame | 34 |
| hardware | 34 |
| metal top panel | 34 |
| perf back panel | 34 |
| shelves | 34 |
| solid back panel | 34 |
| wood base | 34 |

accessories

| | |
|-------------------------------|----|
| base bulkhead | 36 |
| center bottom arm tie down | 39 |
| cover plate | 36 |
| cross bar | 41 |
| end bottom arm tie down | 39 |
| flange bracket | 41 |
| glides | 36 |
| hang rod components | 41 |
| heavy duty wallmount standard | 37 |
| leveler | 36 |
| standard wall tie bracket | 39 |
| super structure locking key | 37 |
| super structure post | 37 |
| super structure u bar | 37 |
| top cap anchor bracket | 39 |
| top cap bracket | 36 |
| touch–up paint | 41 |
| upright & bottom arm tie down | 39 |
| wallmount standard | 37 |

back panels

| | |
|-----------------------------|----|
| perf, 4–way | 34 |
| perf, extender | 26 |
| perf, feature end frame | 33 |
| perf, gondola | 25 |
| slatwall, extender | 26 |
| slatwall, feature end frame | 33 |
| slatwall, gondola | 25 |
| solid, 4–way | 34 |
| solid, bottle bay | 46 |
| solid, extender | 26 |
| solid, feature end frame | 33 |
| solid, gondola | 25 |
| square cut | 25 |

back room

| | |
|------------------|----|
| back room system | 55 |
|------------------|----|

base components

| | |
|--------------------------------|----|
| base nose | 24 |
| base nose end cap | 24 |
| electrical floating kick plate | 24 |
| floating kick plate | 24 |
| flush base | 24 |
| | 24 |

bottle bay

| | |
|--------------------|----|
| bottle bay | 45 |
| double bottom | 46 |
| double end panel | 46 |
| double top | 46 |
| hardware pack | 48 |
| overlay end panels | 48 |
| shelves | 48 |
| single back brace | 47 |
| single base cover | 47 |
| single bottom | 47 |
| single end panel | 47 |
| single top | 47 |
| solid back panels | 46 |

bottom arms & decks

| | |
|-------------------|----|
| center bottom arm | 22 |
| deck | 22 |
| end bottom arm | 22 |

caster components

| | |
|----------|----|
| brace | 38 |
| caster | 38 |
| channel | 38 |
| hardware | 38 |

contour end base

| | |
|------------------|----|
| contour end base | 30 |
|------------------|----|

cornice

| | |
|---------------------------|----|
| metal front | 40 |
| metal return | 40 |
| metal shelf mount bracket | 40 |
| telescoping bracket | 40 |

cross components

| | |
|---------------------|----|
| cross tie | 23 |
| replacement top cap | 23 |
| slatwall tie bar | 23 |
| tie bar | 23 |
| top cap | 23 |

feature end frame

| | |
|---------------------|----|
| bottom angle | 32 |
| feature end frame | 31 |
| hardware | 32 |
| perf back panel | 33 |
| side rail | 32 |
| sign stem fitting | 32 |
| slatwall back panel | 33 |
| solid back panel | 33 |
| t-brace | 31 |
| top channel | 32 |

gondola standards

| | |
|-------------------|----|
| center standard | 21 |
| end standard | 21 |
| extender standard | 21 |

information

| | |
|---|-------|
| base & extender standard assembly | 20 |
| color information | 8 |
| customer directed move-outs | 9 |
| exploded gondola & wallcase | 18 |
| gondola & wallcase component specifications | 12-17 |
| open back components | 19 |
| terms & conditions of sale | 7 |
| unbalanced load calculations | 10 |
| unbalanced load ratings | 11 |

outrigger & widespan

| | |
|-----------|----|
| outrigger | 55 |
| widespan | 56 |

security case components

| | |
|---------------------|----|
| glass door assembly | 35 |
| metal end panels | 35 |
| hardware | 35 |

shelving options

| | |
|-----------------------|----|
| 3" wire fencing | 28 |
| basket/shelf brackets | 29 |
| book shelf adapter | 28 |
| endless wire basket | 29 |
| glass shelf | 29 |
| product retainer | 28 |
| reversible wire shelf | 29 |
| shelf key | 28 |

standard & heavy duty shelves

| | |
|------------------|----|
| heavy duty shelf | 27 |
| standard shelf | 27 |

under counter cabinets

| | |
|---------------------------|----|
| 3 drawer locked narcotics | 53 |
| 3 drawer vial/bottle | 52 |
| 4 drawer accessory | 50 |
| 5 drawer accessory | 51 |
| 5 drawer RX | 53 |
| adjustable shelf | 54 |
| back splash | 54 |
| basic open | 49 |
| counter top | 54 |
| drawer & half door | 50 |
| dual shelf | 49 |
| half modular | 52 |
| high rise end panel | 54 |
| locked drawer | 50 |
| over sink | 53 |
| printer | 51 |
| printer pullout | 52 |
| sink | 51 |
| waste | 49 |

WireFlex™

| | |
|----------------------|----|
| akro bin | 44 |
| base deck | 43 |
| island | 42 |
| monitor tray | 44 |
| reinforced cross bar | 44 |
| shelf | 43 |
| speedwall | 43 |
| telephone tray | 44 |
| tray divider | 44 |
| vial cap bin | 44 |
| wall | 42 |
| wallmount standard | 43 |

Price and Acceptance: Streater reserves the right to change its prices and other terms and/or conditions of sale without notice. All orders placed shall be in writing and become effective only upon acceptance by Streater at its offices in Albert Lea, MN. Streater at its discretion may add handling charges depending on order size and/or order requirements.

Taxes: Buyer agrees to pay all taxes which Streater may be required to assess. If buyer claims a tax exempt status, buyer will provide Streater with a valid tax-exemption certificate.

Payment Terms: Payment to Streater will be cash with order or net 30 days to qualified buyers, upon approval by Streater Credit Department. Overdue payments will be assessed interest charges at the legal rate of the State of Minnesota or the state of the buyer's residence, whichever is greater.

Freight and Delivery: Freight is F.O.B. Albert Lea, MN. Method and route of delivery are at Streater's discretion unless Streater is furnished with complete shipping instructions at least 10 days before the scheduled ship date. Time-sensitive delivery will be handled at Streater's discretion. Quotations for time-sensitive delivery are available upon request. Freight charges will be prepaid and added to the invoice unless otherwise instructed. Streater will endeavor to ship on the requested ship date and every effort will be made to fill orders completely; however, it may be necessary at times to backorder. Streater will not be liable for any delay in the performance of any order or contract, or in the delivery of any goods, or for any damages resulting from such delay, when such delay is due to fire, riots, acts of God, strikes or other events beyond the control of Streater.

Freight and Damage Claims: Freight is F.O.B. Albert Lea MN. What this means is that title to the product is passed on to you when the freight carrier picks up the shipment from Streater and signs the bill of lading. Any freight damage and resultant claims are between you and the freight carrier. It is your responsibility to file a freight claim.

Loss of Freight: Compare the counts of the bill of lading to what you actually receive. Any exception must be noted on the carriers delivery receipt. Failure to note any exception at this time will result in the carrier denying your claim.

Damage of Freight: Damage to goods received must be noted on the carrier's delivery receipt before the driver leaves the place of delivery. Ask the driver for claim forms. If the driver does not have any forms, call the carrier and request claim forms be mailed to you. Generally, if the damage to the product exceeds \$500.00, the carrier must be called for an inspection. Salvage must be held for the carrier (Very important).

Concealed Damage: If goods arrive in apparently good condition, but there is concealed damage, contact the carrier and ask for the goods to be inspected. Keep the product and the packaging material until they have been inspected. A claim needs to be filed with the carrier.

Returned Goods: No equipment may be returned without the advance written approval of an authorized Streater representative. Only stock catalog items may be returned within 60 days of original delivery and items must be in unused condition. A handling and restocking charge of 20 percent of net price will be assessed on all returns. Buyer will forward all returns to Streater freight prepaid and all items must be properly packaged.

Warranty: Streater warrants to original purchaser that the products it manufactures shall be free from defects in material and workmanship and will conform to applicable specifications, drawings, samples, and descriptions. This warranty shall extend for a period of one year from date of delivery to original purchaser for use. Streater, at its option, may repair or replace any products which, upon Streater's inspection, prove to be defective. Except as set forth herein:

THERE ARE NO WARRANTIES, EXPRESS OR IMPLIED, INCLUDING THE IMPLIED WARRANTY OF MERCHANTABILITY. UNDER NO CIRCUMSTANCES SHALL STREATER BE LIABLE FOR ANY CONSEQUENTIAL DAMAGES INCURRED BY ORIGINAL PURCHASER AS A RESULT OF STREATER'S PERFORMANCE UNDER THIS ORDER.

| STANDARD COLORS | TYPE | SET UP COST | LEAD TIME | COLORS |
|-----------------|--|--|--------------|--|
| | Metal | None | Normal | 015–Decor White 0LA–Frosty White 0PP–Platinum Plus 025–Black 0KM–Dove Gray |
| | Wood | None | Normal | 015–Decor White 0LA–Frosty White 0PP–Platinum Plus 0KM–Dove Gray |
| | Base Components | None | Normal | 025–Black 013–Dark Bronze |
| | Plated Components (where indicated) | None | Normal | 082–Zinc plating (satin) 081–Chrome (bright) |
| | Bottle Bay | None | Normal | 0LA–Frosty White |
| OPTIONAL COLORS | | \$500 for wood \$500 for metal per Purchase Order | Normal | 0GX–Skyline Gray 0J8–Bright White 070–Bright Blue 0MT–Liberty Red 0KA–Charcoal 013–Dark Bronze (when not used on base components) 025–Black (wood only) |
| CUSTOM COLORS | | As Quoted | As Quoted | Per customer request |

Customer requested changes to ship dates are subject to approval by Streater. Every reasonable effort will be made to accommodate these requests without additional charges to the customer. However, customer requested move-outs within five (5) working days of the scheduled ship date will be subject to the following:

1. Surcharge

- A. Orders scheduled for picking, packing and loading, but not yet worked on by the warehouse:
LTL orders (less than a full semi-trailer load) will be assessed 5% of the net selling price of the order as a handling fee - minimum \$50/maximum \$250
- B. Trailer-load sized order assessment will be determined by Vice President of Sales or Vice President of Manufacturing.
- C. Jobs picked and sitting on loading dock, but not yet loaded:
 - LTL orders will be assessed 10% of the net selling price of the order as a handling fee - minimum \$100/maximum \$500.
 - Trailer-load sized order: load trailer, invoice customer and charge customer the storage charge for each trailer.
 - For orders in process of being loaded, the assessment would be the same as the bullet above.
 - There is a 20% restocking charge if it is necessary to unload a trailer.

10 unbalanced load calculations

When heavily loading one side of your wall or gondola shelving, it is important to determine if you are creating an unbalanced load that exceeds the maximum design load (SEE LOAD CAPACITY CHART ON PAGE 106). The sample calculation below illustrates how you can determine your unbalanced load in inch-pounds.

NOTE: Inch-pounds are a measure of the shelf loads acting at a distance (½ shelf depth) from the standard (upright).

SAMPLE CALCULATION

STARTER / ADD-ON UNIT TYPE USED FOR ILLUSTRATION

CALCULATE THE UNBALANCED LOAD ACTING ON THIS STANDARD

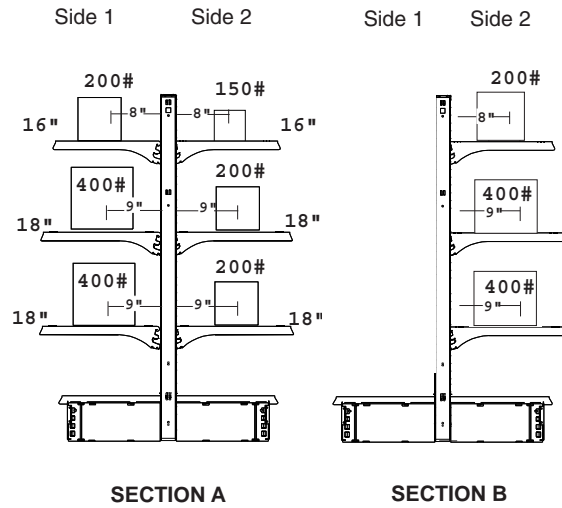
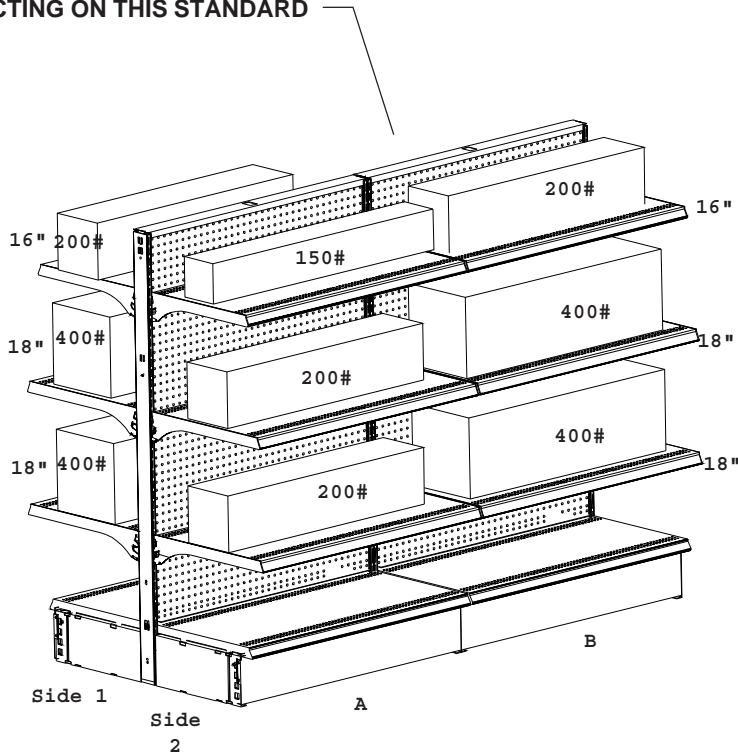

| | Shelf depth , 2 | x | Shelf load , 2 | Side 1 | Side 2 |
|-----------------------|-----------------|---|----------------|--------|--------|
| SECTION A | 8" | x | 100# | 800"# | |
| | 9" | x | 200# | 1800"# | |
| | 9" | x | 200# | 1800"# | |
| | 8" | x | 75# | | 600"# |
| | 9" | x | 100# | | 900"# |
| | 9" | x | 100# | | 900"# |
| SECTION B | no load | | | 0 | |
| | 8" | x | 100# | | 800"# |
| | 9" | x | 200# | | 1800"# |
| | 9" | x | 200# | | 1800"# |
| total (Section A & B) | | | | 4400"# | 6800"# |

Subtract the smaller from the larger 6800"#
 $- 4400\text{"#}$
 Total unbalanced load acting on standard 2400"#

NOTE: Shelf depth is divided by 2 because an **evenly distributed shelf load** is calculated as a total load at center of shelf depth.

Shelf load is divided by 2 because a shelf load is supported by 2 standards.

Deck load does **not** contribute to unbalanced load.

| UNIT TYPE 2½" Standard | INCH-POUND CAPACITY |
|--|------------------------|
| STARTER one unit, with 2 end standards (single uprights) | 3,400"# |
| STARTER/ADD-ON any one unit at either end of run with 1 end standard & 1 center standard (double upright) | 9,500"# |
| STARTER/ADD-ON/FEF any end unit (1 end standard & 1 center standard) at either end of run with feature end attached | 12,000"# |
| ADD-ON/ADD-ON any unit within a run with 2 center standards (double uprights) | 12,000"# |

SPECIAL NOTES:

- Maximum height to depth ratio is 5:1. Any situation where the height of a standard is more than 5 times the length of the bottom arm must be approved by Streater engineering department.
- The maximum unbalanced load on shelves above the joint on an extension standard (upright) should not exceed 2500 inch-pounds.
- The loads applied to perforated back panels should not exceed 150 lbs. per panel.
- Shelf locking keys increase inch-pound capacity by approximately 15%.
- Please check with Streater engineering department for verification if unfamiliar with loading conditions.

12 [>] gondola & wallcase specifications

102
07
REV. 1.06

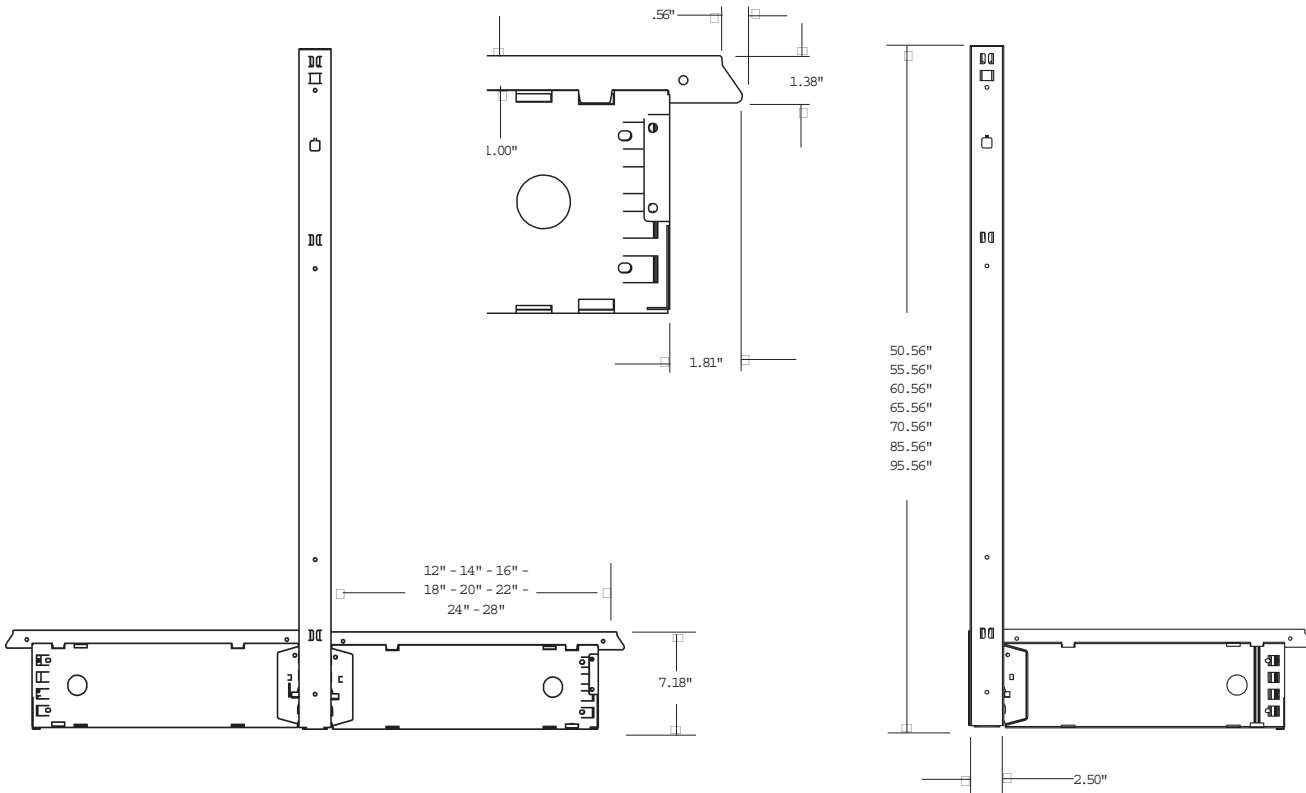

full gondola - trimline

half gondola & wallcase - trimline

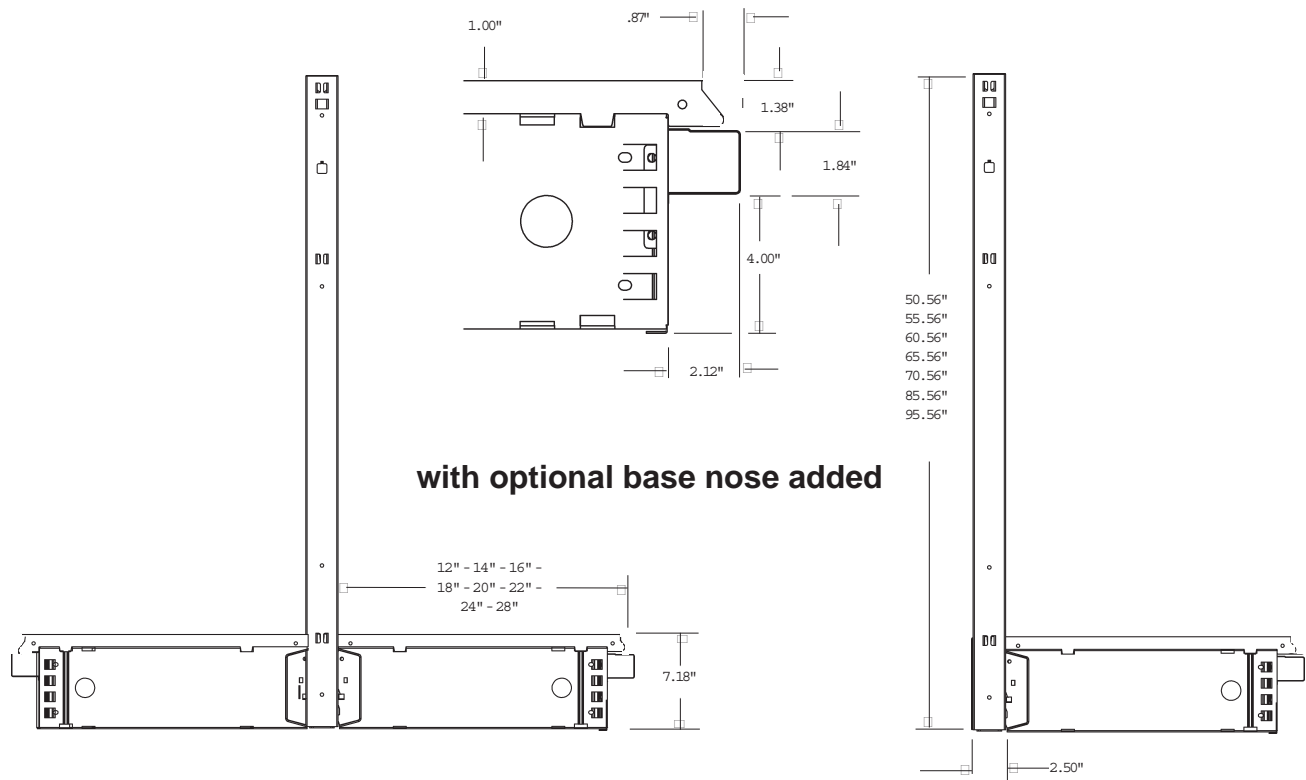

with optional base nose added

full gondola - trimguard

half gondola & wallcase - trimguard

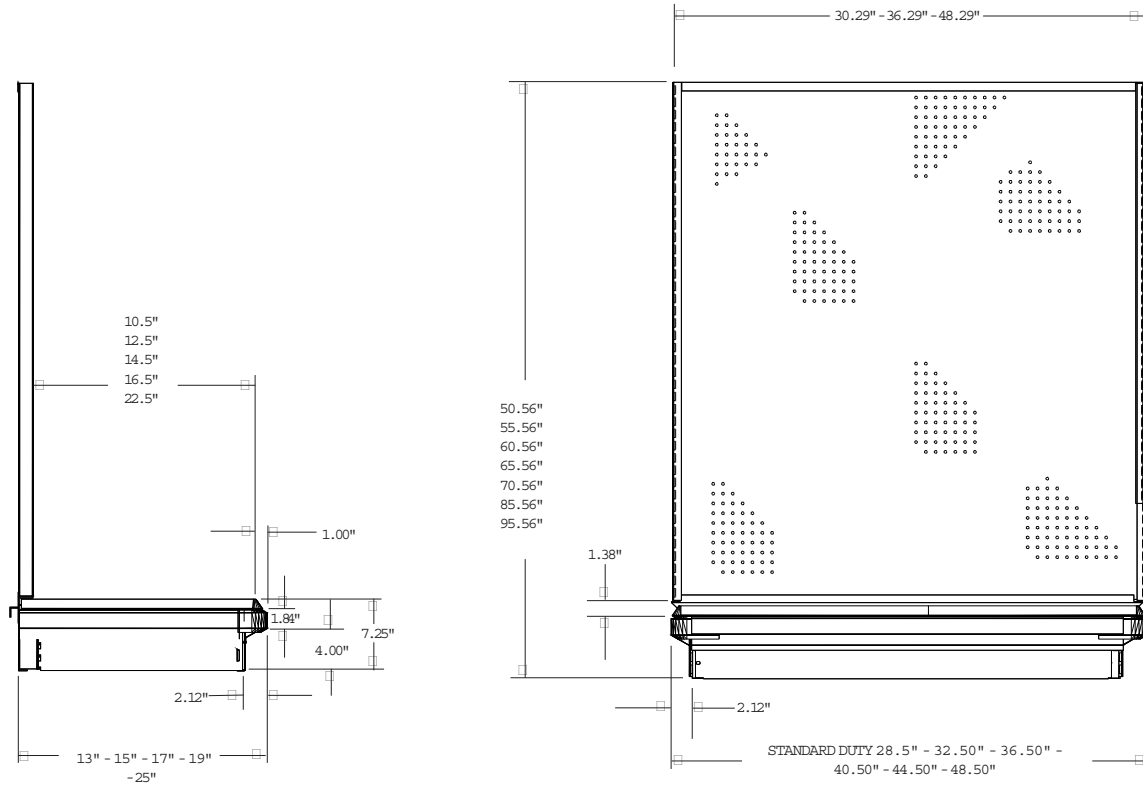

trimguard contour end base with feature end frame

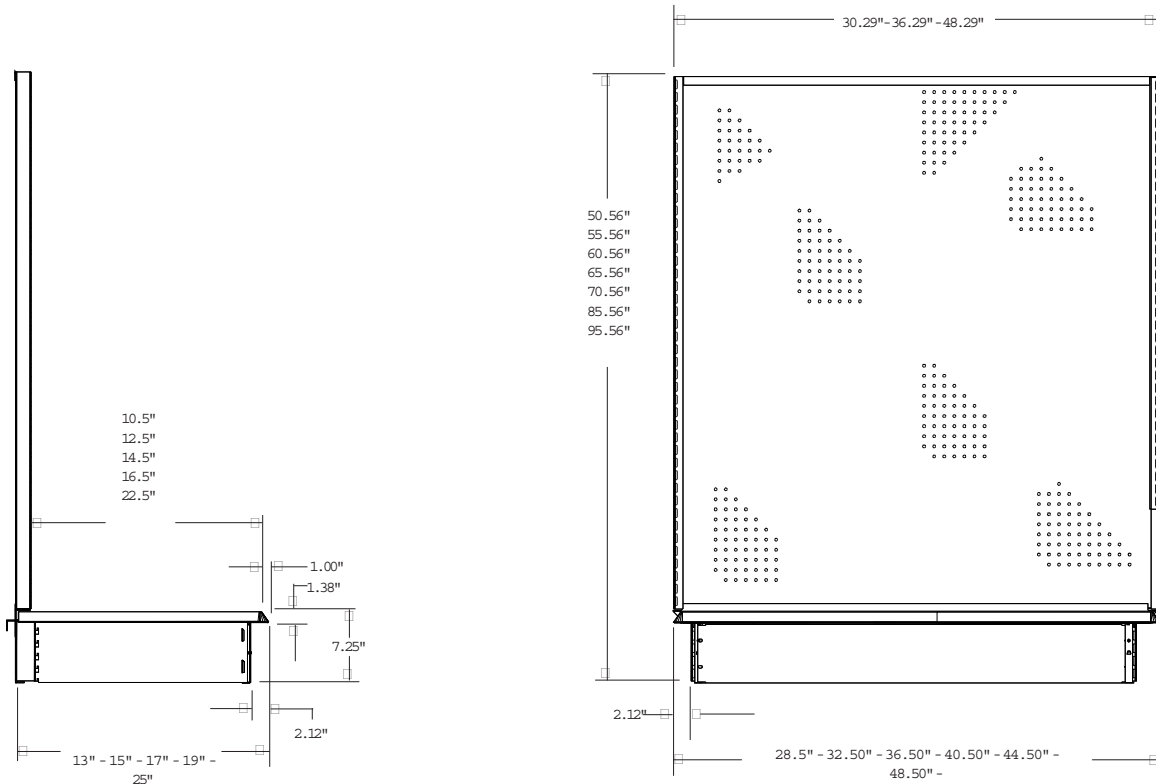

trimline contour end base with feature end frame

standards

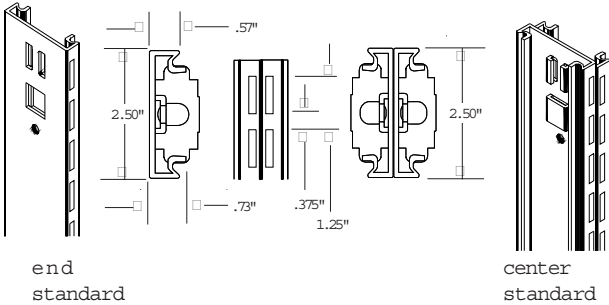

end standard

center standard

- actual heights of standards
37½" - 50½" - 60½" - 65½" - 70½" -
85½" - 95½"
- 12 gauge steel
- baked acrylic enamel

cross tie

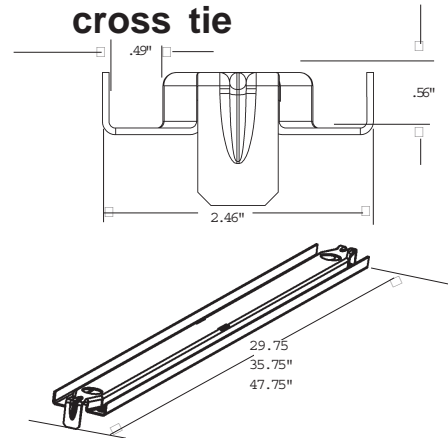

- 30", 36" & 48" module lengths
- kwik-fit™ - no attachment hardware required
- 16 gauge steel
- baked acrylic enamel

top cap

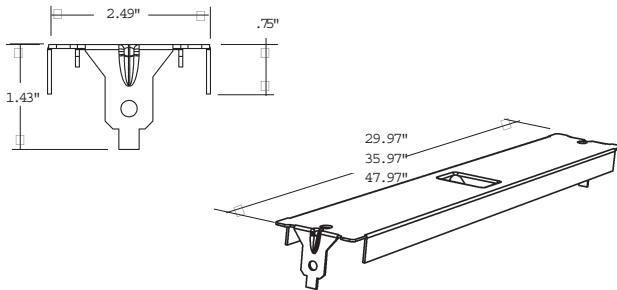

- 30", 36" & 48" module lengths
- kwik-fit™ - no attachment hardware required
- 16 gauge steel
- baked acrylic enamel
- available with electrical outlet

end bottom arm

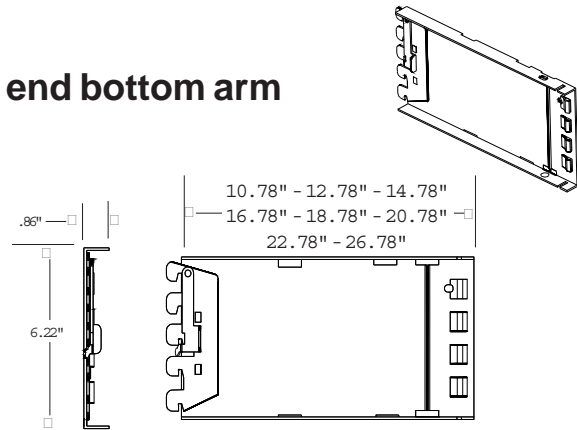

- nominal lengths 12" - 14" - 16" - 18" - 20" - 22" - 24" - 28"
- kwik-fit™ - no attachment hardware required
- 13 gauge high strength steel
- baked acrylic enamel

tie bar

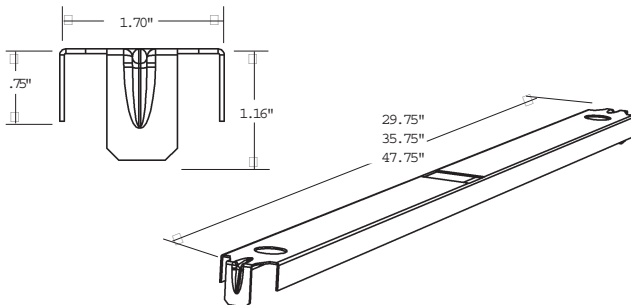

- 30", 36" & 48" module lengths
- kwik-fit™ - no attachment hardware required
- 18 gauge steel
- baked acrylic enamel

center bottom arm

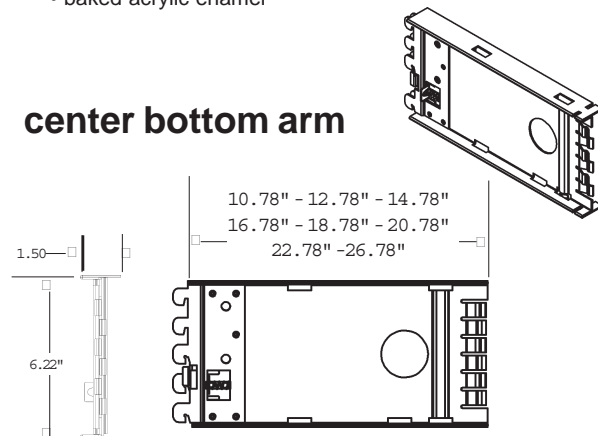

- nominal lengths 12" - 14" - 16" - 18" - 20" - 22" - 24" - 28"
- kwik-fit™ - no attachment hardware required
- 14 gauge steel with 12 gauge steel hooks
- baked acrylic enamel

base deck

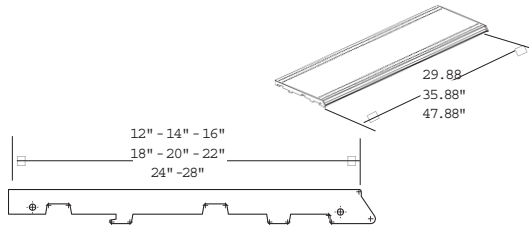

- 30", 36" & 48" module lengths
- one piece 23 gauge embossed steel deck pan with rolled-in 1 1/4" ticket moulding
- welded end plates & reinforcement hat sections
- two row perforations front & rear
- baked acrylic enamel

trimguard base nose

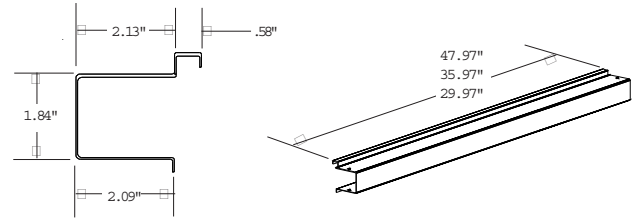

- 30", 36" & 48" module lengths
- protects front of base deck from carts, etc.
- 18 gauge steel
- baked acrylic enamel
- optional item, order as added item to trim-line gondola kits

trimline floating kick plate

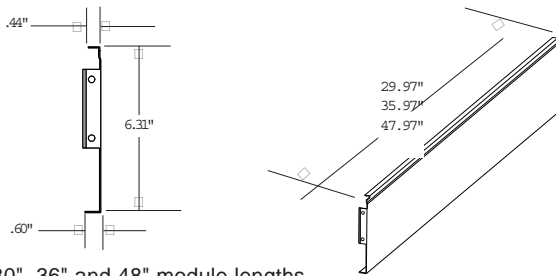

- 30", 36" and 48" module lengths
- 18 gauge steel
- baked acrylic enamel
- available with electrical knockout

trimguard base nose end cap

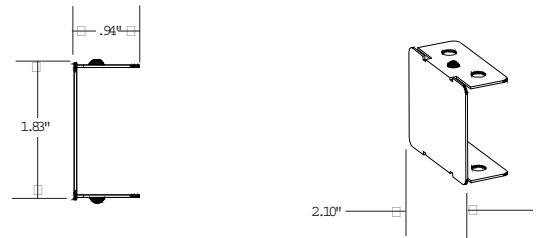

- finishes off ends of trimguard base nose
- two per half starter module & four per full starter module
- 18 gauge steel
- baked acrylic enamel
- optional item, sold individually

nominal 1/4" back panel - finished one side

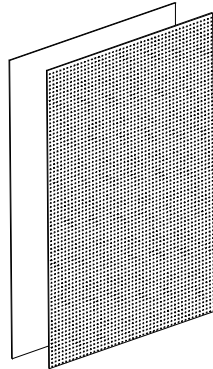

- Perforated or solid backs in choice of standard or optional color - baked enamel (see color chart for reference)

nominal 3/4" slatwall back panel - finished one side

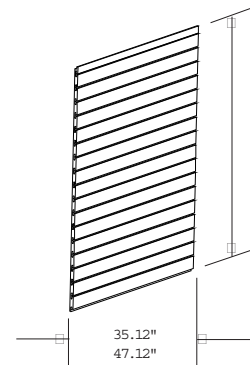

| Fixture Height | Actual Height |
|----------------|---------------|
| 51" | 43.50" |
| 56" | 48.50" |
| 61" | 53.50" |
| 66" | 58.50" |
| 71" | 63.50" |
| 86" | 78.43" |
| 96" | 88.43" |

- slatwall backs in choice of standard or optional color - baked enamel (see color chart for reference)
- with or without steel T-slot inserts

flush base

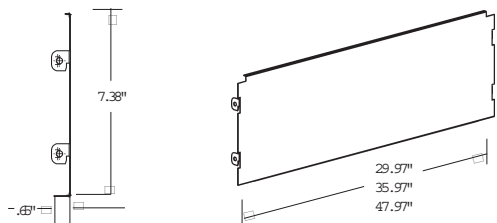

- 30", 36" - 48" module widths
- retains bottom of back panel when no base is required
- 20 gauge steel
- baked acrylic enamel

contour end base

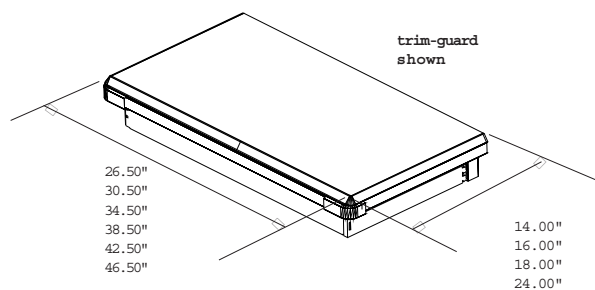

- - 14" - 16" - 18" - 24" nominal depths
- 26" thru 46" nominal widths on standard duty
- fits 14" thru 22" bases both sides
- three row perforations front and three row perforations rear
- baked acrylic enamel
- available in trimguard and trimline

feature end frame

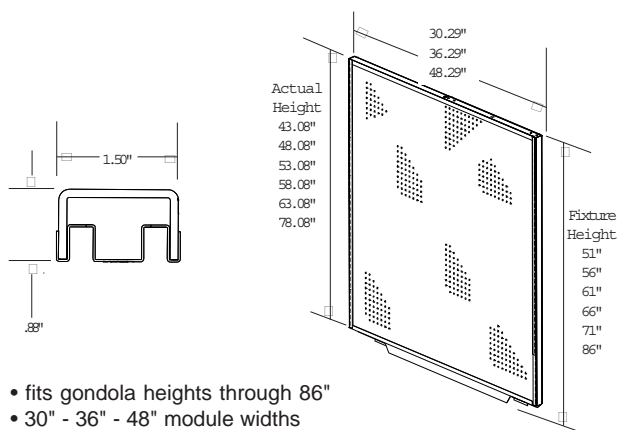

- fits gondola heights through 86"
- 30" - 36" - 48" module widths
- choice of 1/4" back panels
- support plate hooks on bottom arms
- 1-1/4" slot spacing frame, 12 gauge steel
- baked acrylic enamel

wallcase anchoring devices

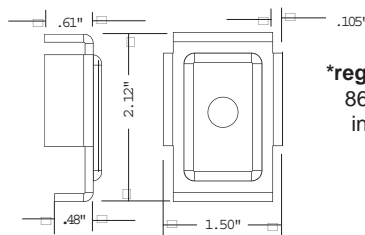

***regular duty(2-1/2" wallcase)**
86" - 96" heights
includes 2 standard wall tie brackets per module

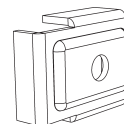

standard wall tie bracket

- 12 gauge steel
- (82) zinc plated

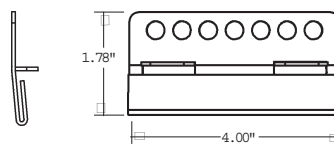

top cap anchoring bracket

- 12 gauge steel
- (82) zinc plated

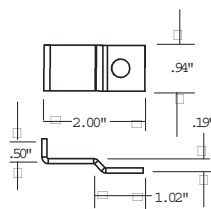
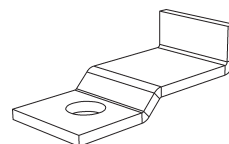

end bottom arm tie down

- 12 gauge steel
- (82) zinc plated

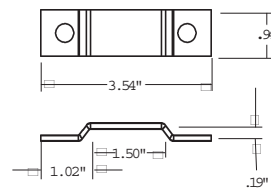
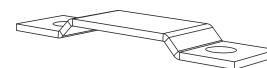

center bottom arm tie down

- 12 gauge steel
- (82) zinc plated